



City of Westminster

Licensing Sub-Committee Report

Item No:	
Date:	18 February 2016
Licensing Ref No:	15/11867/LIPV - Premises Licence Variation
Title of Report:	Unit A2 Moore House Inner Basin Gatliff Road London SW1W 8QN
Report of:	Director of Public Protection and Licensing
Wards involved:	Churchill
Policy context:	City of Westminster Statement of Licensing Policy
Financial summary:	None
Report Author:	Mr Ola Owojori Senior Licensing Officer
Contact details	Telephone: 020 7641 7830 Email: owojori@westminster.gov.uk

1. Application

1-A Applicant and premises			
Application Type:	Variation of a Premises Licence, Licensing Act 2003		
Application received date:	17 December 2015		
Applicant:	New Life Balance Ltd		
Premises:	Unit A2 Moore House		
Premises address:	Inner Basin Gatliff Road London SW1W 8QN	Ward:	Churchill
		Cumulative Impact Area:	No
Premises description:	The premises operates as a restaurant on the ground floor.		
Variation description:	<p>The application is to add sale of alcohol for consumption off the premises and to vary the layout of the premises so as to have a dining area and a retail area.</p> <p>The retail area is to be set aside for customers to buy delicatessen foods such as charcuterie, cheeses, dairy products, fresh pasta and snacks as well as premium wines, beers and spirits to be consumed at home.</p>		
Premises licence history:	The premises are currently licensed, please see the licence history at Appendix 3		
Applicant submissions:	<p>The applicant originally sought to change the layout of the premises and vary sale of alcohol (On & Off) Monday to Sunday 07:00 to 23:00.</p> <p>Following discussion with the Environmental Health Service, the application to vary the hours when alcohol can be consumed on the premises has been withdrawn and the hours for consumption off the premises has been reduced to the Council's core hours.</p> <p>The conditions proposed by the Environmental Health Service have been agreed by the applicant.</p>		

1-B Current and proposed licensable activities, areas and hours

Sale by Retail of Alcohol			
No variation is sought for existing hours permitted for On Sales			
On or off sales	Current :		Proposed:
	On		Off
	Current Hours (On sales)	Proposed Hours (Off sales)	Licensable Area

	only)		only)		Current:	Proposed:
	Start:	End:	Start:	End:		
Monday	11:00	23:00	08:00	23:00	Ground floor	No change
Tuesday	11:00	23:00	08:00	23:00		
Wednesday	11:00	23:00	08:00	23:00		
Thursday	11:00	23:00	08:00	23:00		
Friday	11:00	23:00	08:00	23:00		
Saturday	11:00	23:00	08:00	23:00		
Sunday	11:00	22:30	10:00	22:30		
Seasonal variations:	Current:				Proposed:	
	N/A				No change	
Non-standard timings:	Current:				Proposed:	
	N/A				No change	

Hours premises are open to the public						
	Current Hours		Proposed Hours		Premises Area	
	Start:	End:	Start:	End:	Current:	Proposed:
Monday	11:00	23:00	07:00	23:00	Ground floor	No change
Tuesday	11:00	23:00	07:00	23:00		
Wednesday	11:00	23:00	07:00	23:00		
Thursday	11:00	23:00	07:00	23:00		
Friday	11:00	23:00	07:00	23:00		
Saturday	11:00	23:00	07:00	23:00		
Sunday	11:00	22:30	07:00	23:00		
Seasonal variations:	Current:				Proposed:	
	N/A				No change	
Non-standard timings:	Current:				Proposed:	
	N/A				No change	

1-C Layout alteration
Layout alteration so as to add a retail area where delicatessen foods such as charcuterie, cheeses, dairy products, fresh pasta and snacks as well as premium wines, beers and spirits

2. Representations

2-A Responsible Authorities	
Responsible Authority:	Environmental Health
Representative:	Dave Nevitt
Received:	7 January
I refer to the above application which seeks to vary Premises Licence 15/07943/LIPT to include the following (as described by the applicant):	
'This application is to add a variation to sell alcohol to be consumed off the premises to the existing license. The premises are situated within a residential development, Grosvenor Waterside, and the internal layout will be divided into two areas:	

a large dining area where customers will be seated and served alcohol to be consumed with a substantial meal, and a retail area where customers can buy delicatessen foods such as charcuterie, cheeses, dairy products, fresh pasta and snacks as well as premium wines, beers and spirits to be consumed at home.'

I wish to make Representations on the following grounds:

Representation is made in relation to the application, as the proposals are likely to increase Public Nuisance and may impact upon Public Safety.

The current Licence already has Conditions in respect of CCTV, Challenge 21, Incident Log and MC66.

The premises is already authorised to operate as a restaurant where alcohol is consumed 'On' the premises and ancillary to a table meal. The applicant seeks to add 'Off' Sales of alcohol from a retail area of the premises.

I propose that the existing Condition 13 (MC66) is amended to indicate that it applies to 'On' sales only.

The hours for 'On' Sales shall remain as per the current Licence.

I also propose that the following conditions are applied in respect to 'Off' Sales of Alcohol:

1. All tills shall automatically prompt staff to ask for age verification identification when presented with an alcohol sale.
2. Outside of the hours authorised for the sale of alcohol and whilst the premises are open to the public, the licence holder shall ensure that all alcohol within the premises (including alcohol behind the counter) is secured in a locked store room or behind locked grilles, locked screens or locked cabinet doors so as to prevent access to the alcohol by both customers and staff.
3. No super-strength beer, lagers, ciders or spirit mixtures of 5.5% ABV (alcohol by volume) or above shall be sold at the premises, except for premium beers and ciders supplied in glass bottles.
4. No more than (15)% of the sales area shall be used at any one time for the sale, exposure for sale, or display of alcohol.
5. There shall be no self service of spirits on the premises, save for spirit mixtures less than 5.5% ABV.
6. Prominent signage indicating the permitted hours for the sale of alcohol shall be displayed so as to be visible before entering the premises, where alcohol is on public display, and at the point of sale.

Responsible Authority:	Police
Representative:	PC Bryan Lewis
Received:	7 January

With reference to the above application I am writing to inform you that the Police, as a Responsible Authority, object to your application for a new Premises Licence as it is our belief that if granted the application would undermine the Licensing Objectives.

Our objections relate to the following:

- There are insufficient conditions to promote the Licensing objectives.
- The hours applied for in relation to the sale of alcohol, are earlier than core hours as set out in the Westminster Council Statement of Licensing Policy.

Please consider EH conditions as combined Police suggested conditions. I will liaise with Dave regarding whether our concerns are addressed.

2-B Other Persons			
Name:	Jim McDonald		
Address and/or Residents Association:	Purple Dragon Bramah House Grosvenor Waterside 30 Gatliff Road London SW1W 8DP		
Status:	Business	In support or opposed:	Opposed
Received:	11 January		



Purple Dragon
Bramah House
Grosvenor Waterside
30 Gatliff Road
London
SW1W 8DP
8th January 2016

Dear Sir/Madam

Re: New Life Balance application to vary the premises licence for Unit A2, Inner Basin, Gatliff Road, SW1W 8QN

Today we read with interest the application to vary the licence for Unit A2 of the Grosvenor Waterside Estate ('the Estate'), the former Old Tree site. Displayed in the window is the Variation document submitted to the Council as well as a letter entitled "Hello Grosvenor Waterside Residents", which is included with this letter for your information.

As the operator of a family club with many young children within the Estate, we are concerned that loud and/or anti-social behaviour may arise from the sale of alcohol for consumption on or off the premises.

We understand this is a change as previously alcohol sales were only permitted within the Unit itself and would like to know the following:

- a) Will all food and drink for consumption on site be within the premises or will tables/chairs be set up outside and food/alcohol served there as well?
- b) Can New Life Balance ('NLB') provide any assurances or put any safeguards in place to ensure that loud and/or anti-social behaviour does not start to appear on the Estate as a result of alcohol being available to takeaway.
- c) Alcohol is only sold as part of a substantial meal, rather than this becoming a drinking establishment.

We are keen to avoid it becoming the local bar as Unit A2 is very visible, facing directly onto Civic Square. It is the first thing our members and other visitors see when they arrive at Grosvenor Waterside, setting the tone for the Estate.

We would also like clarification on a number of other areas:

Retail part of the business

The letter to the residents states that NLB will be selling and delivering food, alcohol, soft drinks and products from 7am to 11pm. From the floor plans we can see that a sizeable area has been set-aside for Retail. We would like clarity on what these products will be.

Takeaway business

We would like more information on what food will be available for takeaway and delivery (e.g. pizzas from the pizza oven) and whether the hours of operation of this concierge delivery service/takeaway will match those of the restaurant (7am to 11pm).

Food delivery business

We would like to know whether NLB anticipates this takeaway/delivery business will be restricted just to Grosvenor Waterside or whether deliveries of food/products/alcohol will be made elsewhere.

If deliveries will be made off site, how will these be transported? If a vehicle or vehicles are to be used, where these will be parked and will this have much of an impact on traffic flow/noise in and around Civic Square?

Supplier deliveries

From a traffic management perspective we would also like to confirm that all suppliers to NLB will use the delivery bay rather than creating traffic management issues within Civic Square.

If New Life Balance has already provided you with the above information, we would be very grateful if you would send us the summary or the detailed due diligence documents. This can either be in hard copy to the above address or via email to GM@purpledragonplay.com.

Until we have clarity around the use of the premises and some more information about safeguards against anti-social behaviour arising from alcohol sales, we must register our objection to the application to vary the licence.

Yours faithfully

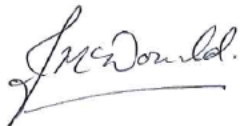

Jim McDonald
General Manager, Purple Dragon Chelsea.

Hello Grosvenor Waterside Residents!

We are opening a restaurant and a deli shop here in early 2016. We aim to be a community hub catering to all the food and drink needs of you, the local residents of Grosvenor Waterside development.

We will be serving, selling and delivering healthy, seasonal, fresh food, drinks and products from 7am to 11pm.

Our concept combines the convenience of a cosy restaurant, an upmarket deli and concierge delivery service.

We will be serving breakfast, lunch, dinner and weekend brunches for you to enjoy. Excellent coffee, green juices and healthy smoothies will also be available throughout the day.

The premises license of previous tenants, Old Tree Bakery, allows us to sell alcohol to you to enjoy as part of a meal but we would also like to sell fine wines, craft beers and premium spirits for you to take away home. Alongside our selection of wines and spirits, we will offer fine foods from Italy, France and the UK.

Hence the blue notice next to this note- we've applied to vary the existing license to be able to sell alcohol both on and off the premises. We hope you will agree that Grosvenor Waterside would really benefit from a nice deli shop and support our efforts.

We are personally licensed to be selling alcohol and will make sure to take every effort to promote the licensing objectives. We are very happy to answer any questions you might have.
Get in touch with us on info@newlifebalance.co.uk

All the best,
Olga and Evgeniya
The New Life Balance Team

3. Policy & Guidance

The following policies within the City Of Westminster Statement of Licensing Policy apply:	
Policy HRS1 applies:	(i) Applications for hours within the core hours set out below in this policy will generally be granted, subject to not being contrary to other policies in the Statement of Licensing Policy. (ii) Applications for hours outside the core hours set out below in this policy will be considered on their merits, subject to other relevant policies.
Policy OS1 applies:	Applications will generally be granted and reviews determined subject to the relevant criteria in Policies CD1, PS1, PN1 CH1 and HRS1 and other policies in this Statement.

4. Appendices

Appendix 1	Premises plans
Appendix 2	Applicant supporting documents
Appendix 3	Premises history
Appendix 4	Proposed conditions
Appendix 5	Residential map and list of premises in the vicinity

Report author:	Mr Ola Owojori Senior Licensing Officer
Contact:	Telephone: 020 7641 7830 Email: owojori@westminster.gov.uk

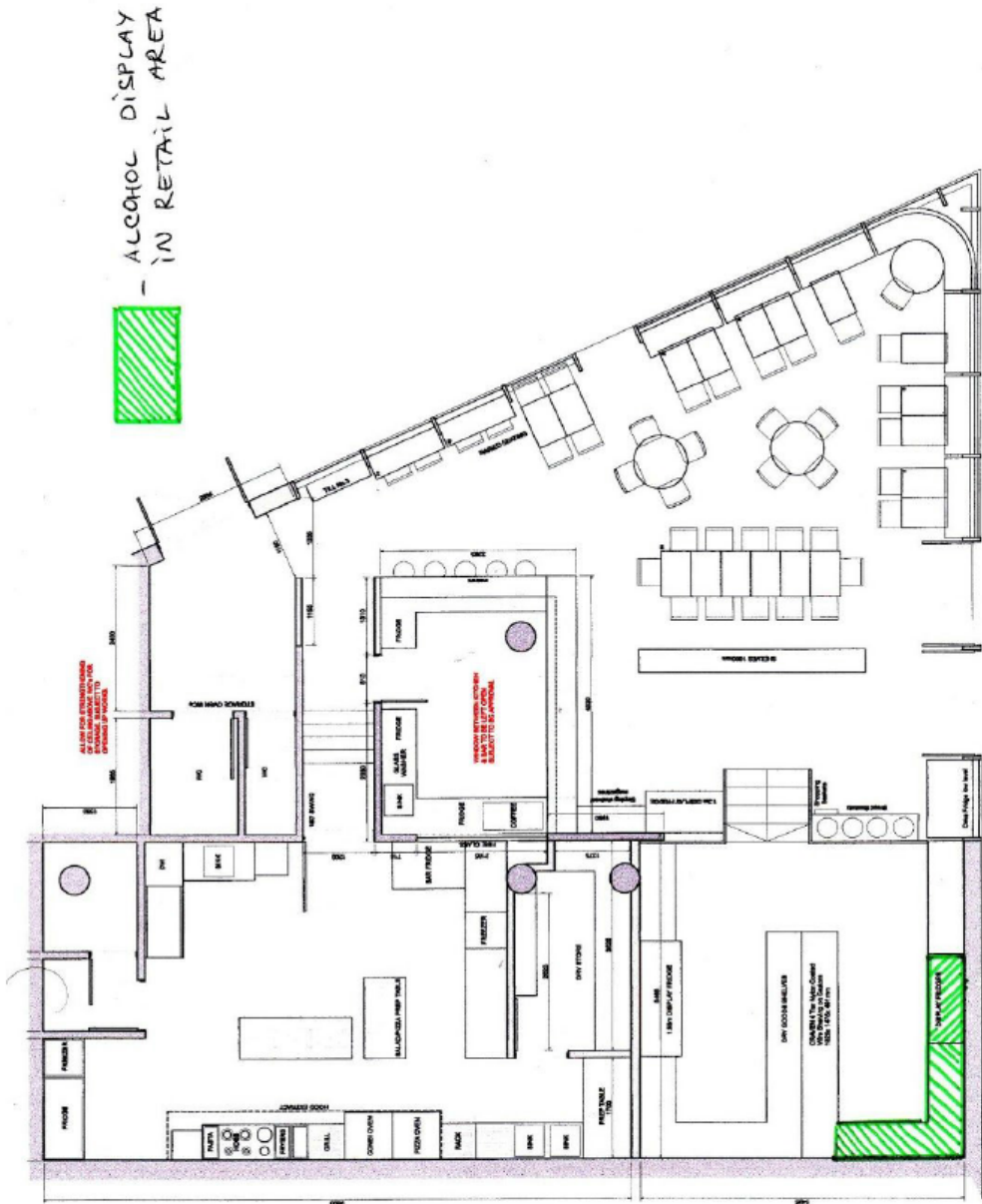

Latitude Portal

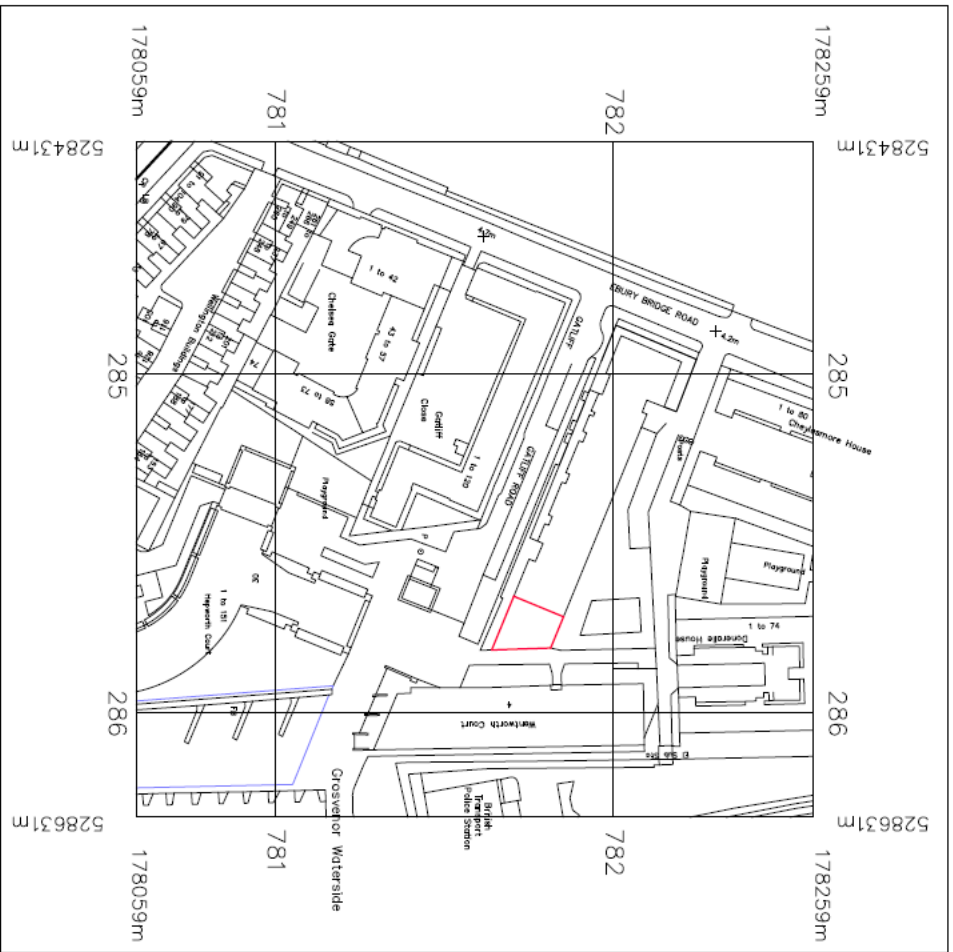

© Crown Copyright 2013
 Reproduction in whole or in part is prohibited
 without the prior permission of Ordnance Survey.

PREMISES LICENCE

man & man P I E R C E S	TRADING AS OLD TREE UNIT 2A GROSVENOR WATERSIDE LONDON SW1W 0JN	POINT OF COMMENCEMENT 11/12/2013
104, Old Tree Lane, London SW1W 0JN	TITLE O.S. PLAN	DATE DECEMBER 2013
104, Old Tree Lane, London SW1W 0JN		EXPIRES 31/12/2014

Hi Dave

We agree to the condition. We noticed Sainsbury's on the corner has a similar sign on the outside of their shop so will follow suit.

Thanks very much,
Evgeniya

Hi Dave

Many thanks for your email and the proposed conditions.

We agree to these conditions entirely. However, could you please advise us what is meant by a prominent signage indicating the permitted hours for the sale alcohol visible before entering the premises. We are restricted as to what we could put outside of the premises and to be honest I've never seen a sign with alcohol sale hours on a street before. We are happy to comply yet seeking you advice as to how to do it correctly.

In regards to your other proposed conditions, we have already made provisions as to how to shut alcohol away during restricted hours and have no objections to the other listed conditions.

Regards
Evgeniya

Hi Dave,

Thanks for your email and we are glad to hear that we can deal with all issues in one application.

I can confirm that the statements in relation to new layout and sale and supply of alcohol on and off premises are all correct.

We look forward to receiving the Proposed Conditions when they are ready.

Let me know if there's any additional information you require from us to support our application.

Best regards,
Evgeniya

Best wishes,
Olga Lordier
Evgeniya Petrova

New Life Balance Ltd
A: 28 Hepworth Court, 30 Gatliff Road
SW1W8QN, London, UK
P: +447717688103, +447703733306
E: info@newlifebalance.co.uk

On Wed, Jan 27, 2016 at 9:38 AM, Nevitt, Dave <dnevitt@westminster.gov.uk> wrote:

Hi Evgeniya,

Yes, I have discussed this with Licensing (Sumeet, copied into this email. I have also copied in Bryan Lewis, Police). It seems that we should be able to deal with everything under the current application. I would be grateful if you would confirm the following:

1. The plans submitted with the application show how you intend to arrange the internal layout of the premises.

2. The hours for the sale/supply of alcohol for consumption 'On' the premises (the restaurant) are to remain as per the existing Licence.

3. The hours for the sale/supply of alcohol for consumption 'Off' the premises (the shop part) are to be amended in order to accord with the City Council's 'Core Hours' for off-sales: Monday to Saturday 0800hrs-2300hrs, and Sunday 1000hrs-2230hrs.

I will send you some Proposed Conditions for consideration in due course.

Licence & Appeal History

Application	Details of Application	Date Determined	Decision
New	Application for a new premises licence	29.5.14	Granted by the Licensing Sub-Committee
Transfer	Transfer from Old Tree Ltd to New Life Balance Ltd	1.10.15	Granted under delegated authority

There is no appeal history

CONDITIONS CONSISTENT WITH THE OPERATING SCHEDULE AND CONDITIONS PROPOSED BY A PARTY TO THE HEARING

When determining an application for a new premises licence under the provisions of the Licensing Act 2003, the licensing authority must, unless it decides to reject the application, grant the licence subject to the conditions which are indicated as mandatory in this schedule.

At a hearing the licensing authority may, in addition, and having regard to any representations received, grant the licence subject to such conditions which are consistent with the operating schedule submitted by the applicant as part of their application, or alter or omit these conditions, or add any new condition to such extent as the licensing authority considers appropriate for the promotion of the licensing objectives.

This schedule lists those conditions which are consistent with the operating schedule, or proposed as appropriate for the promotion of the licensing objectives by a responsible authority or an interested party as indicated. These conditions have not been submitted by the licensing service but reflect the positions of the applicant, responsible authority or interested party and have not necessarily been agreed

Conditions: On Current Licence -

Mandatory:

1. No supply of alcohol may be made at a time when there is no designated premises supervisor in respect of this licence.
2. No supply of alcohol may be made at a time when the designated premises supervisor does not hold a personal licence or the personal licence is suspended.
3. Every supply of alcohol under this licence must be made or authorised by a person who holds a personal licence.
4.
 - (1) The responsible person must ensure that staff on relevant premises do not carry out, arrange or participate in any irresponsible promotions in relation to the premises.
 - (2) In this paragraph, an irresponsible promotion means any one or more of the following activities, or substantially similar activities, carried on for the purpose of encouraging the sale or supply of alcohol for consumption on the premises—
 - (a) games or other activities which require or encourage, or are designed to require or encourage, individuals to;
 - (i) drink a quantity of alcohol within a time limit (other than to drink alcohol sold or supplied on the premises before the cessation of the period in which the responsible person is authorised to sell or supply alcohol), or
 - (ii) drink as much alcohol as possible (whether within a time limit or otherwise);

- (b) provision of unlimited or unspecified quantities of alcohol free or for a fixed or discounted fee to the public or to a group defined by a particular characteristic in a manner which carries a significant risk of undermining a licensing objective;
 - (c) provision of free or discounted alcohol or any other thing as a prize to encourage or reward the purchase and consumption of alcohol over a period of 24 hours or less in a manner which carries a significant risk of undermining a licensing objective;
 - (d) selling or supplying alcohol in association with promotional posters or flyers on, or in the vicinity of, the premises which can reasonably be considered to condone, encourage or glamorise anti-social behaviour or to refer to the effects of drunkenness in any favourable manner;
 - (e) dispensing alcohol directly by one person into the mouth of another (other than where that other person is unable to drink without assistance by reason of a disability).
5. The responsible person must ensure that free potable water is provided on request to customers where it is reasonably available.
6. (1) The premises licence holder or club premises certificate holder must ensure that an age verification policy is adopted in respect of the premises in relation to the sale or supply of alcohol.
- (2) The designated premises supervisor in relation to the premises licence must ensure that the supply of alcohol at the premises is carried on in accordance with the age verification policy.
- (3) The policy must require individuals who appear to the responsible person to be under 18 years of age (or such older age as may be specified in the policy) to produce on request, before being served alcohol, identification bearing their photograph, date of birth and either—
- (a) a holographic mark, or
 - (b) an ultraviolet feature.
7. The responsible person must ensure that—
- (a) where any of the following alcoholic drinks is sold or supplied for consumption on the premises (other than alcoholic drinks sold or supplied having been made up in advance ready for sale or supply in a securely closed container) it is available to customers in the following measures—
 - (i) beer or cider: ½ pint;
 - (ii) gin, rum, vodka or whisky: 25 ml or 35 ml; and
 - (iii) still wine in a glass: 125 ml;

- (b) these measures are displayed in a menu, price list or other printed material which is available to customers on the premises; and
- (c) where a customer does not in relation to a sale of alcohol specify the quantity of alcohol to be sold, the customer is made aware that these measures are available.

A responsible person in relation to a licensed premises means the holder of the premise licence in respect of the premises, the designated premises supervisor (if any) or any individual aged 18 or over who is authorised by either the licence holder or designated premises supervisor. For premises with a club premises certificate, any member or officer of the club present on the premises in a capacity that which enables him to prevent the supply of alcohol.

8(i) A relevant person shall ensure that no alcohol is sold or supplied for consumption on or off the premises for a price which is less than the permitted price.

8(ii) For the purposes of the condition set out in paragraph 8(i) above -

- (a) "duty" is to be construed in accordance with the Alcoholic Liquor Duties Act 1979;
- (b) "permitted price" is the price found by applying the formula -

$$P = D+(D \times V)$$

Where -

- (i) P is the permitted price,
 - (ii) D is the amount of duty chargeable in relation to the alcohol as if the duty were charged on the date of the sale or supply of the alcohol, and
 - (iii) V is the rate of value added tax chargeable in relation to the alcohol as if the value added tax were charged on the date of the sale or supply of the alcohol;
- (c) "relevant person" means, in relation to premises in respect of which there is in force a premises licence -
- (i) the holder of the premises licence,
 - (ii) the designated premises supervisor (if any) in respect of such a licence, or
 - (iii) the personal licence holder who makes or authorises a supply of alcohol under such a licence;
- (d) "relevant person" means, in relation to premises in respect of which there is in force a club premises certificate, any member or officer of the club present on the premises in a capacity which enables the member or officer to prevent the supply in question; and

- (e) "value added tax" means value added tax charged in accordance with the Value Added Tax Act 1994.
- 8(iii). Where the permitted price given by Paragraph 8(ii)(b) above would (apart from this paragraph) not be a whole number of pennies, the price given by that sub-paragraph shall be taken to be the price actually given by that sub-paragraph rounded up to the nearest penny.
- 8(iv).
 - (1) Sub-paragraph 8(iv)(2) below applies where the permitted price given by Paragraph 8(ii)(b) above on a day ("the first day") would be different from the permitted price on the next day ("the second day") as a result of a change to the rate of duty or value added tax.
 - (2) The permitted price which would apply on the first day applies to sales or supplies of alcohol which take place before the expiry of the period of 14 days beginning on the second day.

Annex 2 – Conditions consistent with the operating Schedule

None

Annex 3 – Conditions attached after a hearing by the licensing authority

- 9. The premises shall install and maintain a comprehensive CCTV system as per the minimum requirements of the Westminster Police Licensing Team. All entry and exit points will be covered enabling frontal identification of every person entering in any light condition. The CCTV system shall continually record whilst the premises is open for licensable activities and during all times when customers remain on the premises. All recordings shall be stored for a minimum period of 31 days with date and time stamping. Viewing of recordings shall be made available immediately upon the request of Police or authorised officer throughout the preceding 31 day period.
- 10. A staff member from the premises who is conversant with the operation of the CCTV system shall be on the premises at all times when the premises is open. This staff member must be able to provide a Police or authorised council officer copies of recent CCTV images or data with the absolute minimum of delay when requested.
- 11. A Challenge 21 proof of age scheme shall be operated at the premises where the only acceptable forms of identification are recognised photographic identification cards, such as a driving licence, passport or proof of age card with the PASS Hologram.
- 12. An incident log shall be kept at the premises, and made available on request to an authorised officer of the City Council or the Police, which will record the following:
 - (a) all crimes reported to the venue;
 - (b) all ejections of patrons;
 - (c) any complaints received concerning crime and disorder;
 - (d) any incidents of disorder;
 - (e) all seizures of drugs or offensive weapons;

- (f) any faults in the CCTV system or searching equipment or scanning equipment;
- (g) any refusal of the sale of alcohol;
- (h) any visit by a relevant authority or emergency service.

13. The premises shall only operate as a restaurant:
- (i) in which customers are shown to their table,
 - (ii) where the supply of alcohol is by waiter or waitress service only,
 - (iii) which provide food in the form of substantial table meals that are prepared on the premises and are served and consumed at the table using non disposable crockery,
 - (iv) which do not provide any take away service of food or drink for immediate consumption,
 - (v) which do not provide any take away service of food or drink after 23.00, and
 - (vi) where alcohol shall not be sold or supplied, otherwise than for consumption by persons who are seated in the premises and bona fide taking substantial table meals there, and provided always that the consumption of alcohol by such persons is ancillary to taking such meals.

Notwithstanding this condition customers are permitted to take from the premises part consumed and resealed bottles of wine supplied ancillary to their meal.

14. No waste or recyclable materials, including bottles, shall be moved, removed from or placed in outside areas between 23:00 hours and 08:00 hours on the following day.
15. All waste shall be properly presented and placed out for collection no earlier than 30 minutes before the scheduled collection times.
16. Substantial food and non-intoxicating beverages, including drinking water, shall be available in all parts of the premises where alcohol is sold or supplied for consumption on the premises.
17. No collections of waste or recycling materials (including bottles) from the premises shall take place between 23:00 and 08:00 on the following day.
18. No deliveries to the premises shall take place between 23:00 and 08:00 on the following day.
19. The Licence will have no effect until the premises has been assessed as satisfactory by the Environmental Health Consultation Team and this condition has been removed from the Licence.

Environmental Health conditions agreed by the applicant

20. All tills shall automatically prompt staff to ask for age verification identification when presented with an alcohol sale.
21. Outside of the hours authorised for the sale of alcohol and whilst the premises are open to the public, the licence holder shall ensure that all alcohol within the premises (including alcohol behind the counter) is secured in a locked store room or

behind locked grilles, locked screens or locked cabinet doors so as to prevent access to the alcohol by both customers and staff.

22. No super-strength beer, lagers, ciders or spirit mixtures of 5.5% ABV (alcohol by volume) or above shall be sold at the premises, except for premium beers and ciders supplied in glass bottles.
23. No more than (15)% of the sales area shall be used at any one time for the sale, exposure for sale, or display of alcohol.
24. There shall be no self service of spirits on the premises, save for spirit mixtures less than 5.5% ABV.
25. Prominent signage indicating the permitted hours for the sale of alcohol shall be displayed so as to be visible before entering the premises, where alcohol is on public display, and at the point of sale.

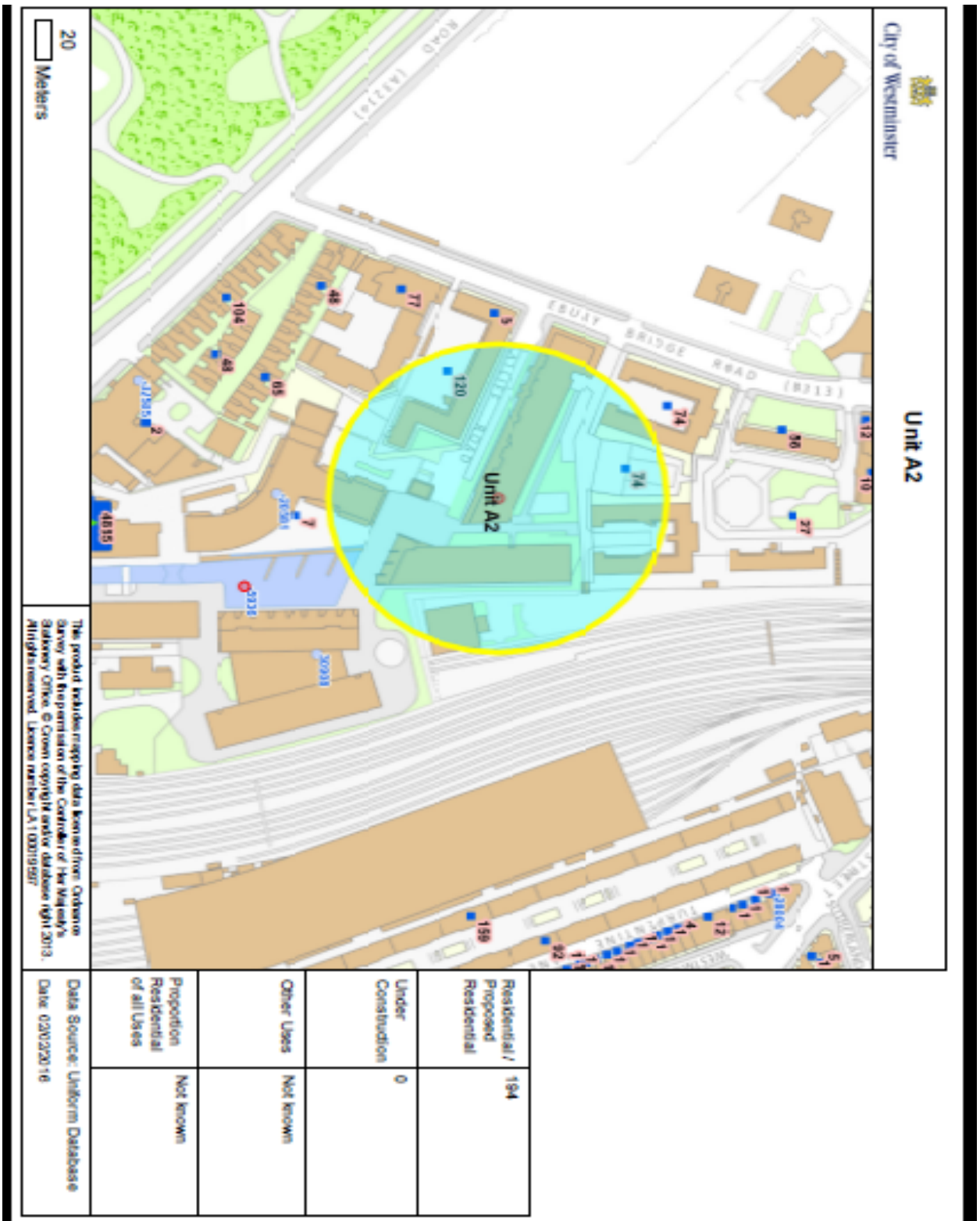

If you have any queries about this report or wish to inspect one of the background papers please contact the report author.

Background Documents – Local Government (Access to Information) Act 1972

1	Licensing Act 2003	N/A
2	City of Westminster Statement of Licensing Policy	7 th January 2011
3	Amended Guidance issued under section 182 of the Licensing Act 2003	March 2015
4	Existing Licence	18/12/15
5	Plans	18/12/15
6	Application served and acknowledged	18/12/15
7	Public Notice	18/12/15
8	Application	18/12/15
9	Police representation	7/1/16
10	Environmental Health representation	7/1/16
11	Confirmation of application	29/1/16
12	Local resident representation	29/1/16
13	Notification of hearing	2/2/16
14	Environmental Health Conditions	4/2/16
15	Applicant's correspondence with the Police	8/2/16
16	Environmental Health conditions agreed	10/2/16
17		
18		
19		
20		
21		
22		
23		
24		